

# Roy Chand Engineers

Engineers & Architects

RCE

Building Plan, Design, Structural, Geotechnical Consultant & Contractor

## SITE PLAN OF PREMISES NO. 32 /1, K.P.ROY LANE, WARD NO.- 92, BOROUGH NO. - X , P.S. - GARFA, UNDER THE K.M.C, KOLKATA - 700031

AREA OF LAND = ( 7K-15CH.-10SFT. ) = 531.865 SQ.M.  
G+IV BUILDING

Lat. N 22°30'11.30904"  
Lng. E 88°22'48.67824"

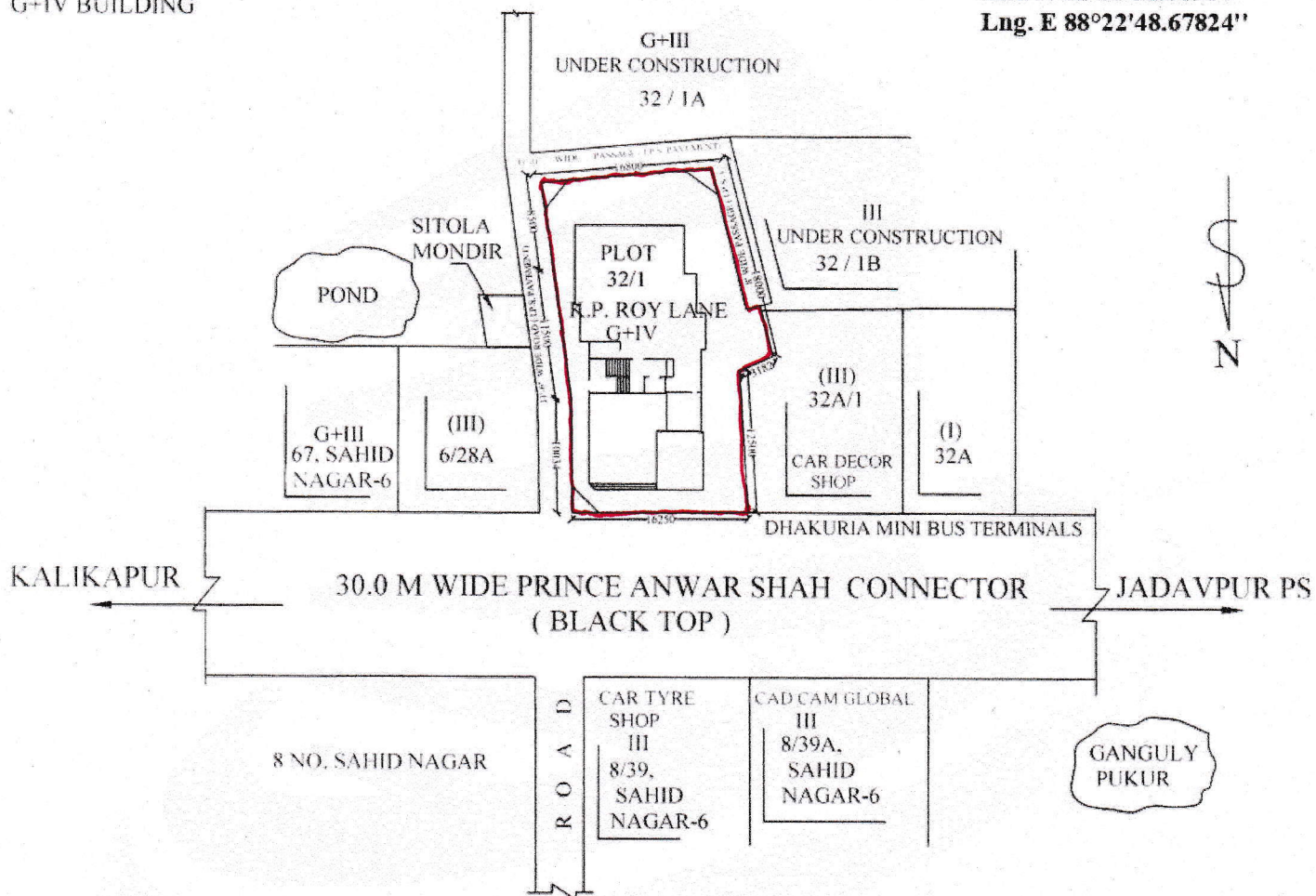

SITE PLAN  
SCALE- 1:600

L.B.S. - SOUMYA ROY, M.E., NO. 1371/I  
E.S.E. - SOUMYA ROY, M.E., NO. 192/I  
G.T.E. - SOUMYA ROY, M.E., NO. 25/I  
ADDRESS OF SOUMYA ROY  
6 RAYKRISHNA PALEY, KOLKATA-700078.  
MOBILE NO. 9123364478 9331041577

  
GOURI ROY (CHANDGADKAR), B.E. (CIVIL)  
LBS, CLASS-1, No-1530  
KOLKATA MUNICIPAL CORPORATION  
GOURI ROY (CHANDGADKAR), B.E. (CIVIL)  
LBS, CLASS-1 NO-1530  
KOLKATA MUNICIPAL CORPORATION  
MOBILE NO. 9163098255  
SIG. OF L. B. S.